

## MS-MBC-6-F4-6

**Lens Technology Enabled™ Multi-Beam Base-Station Antenna perfect for multi-sector cell site deployments, utilizes a patented cylindrical lens design with 6 isolated F-Band (3300– 4200 MHz) cross-polarized beams. Each Beam has 4 ports to Support 4x4 MIMO.**

**RET (Smart Bias Tee & AISG 2.0) with 2°-10° for each beam.**

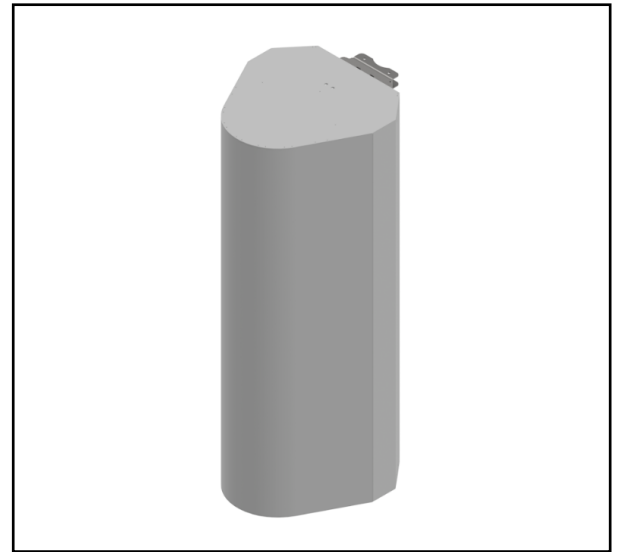

### PATTERN RESULTS:

**Horizontal Pattern (3.7GHz)**

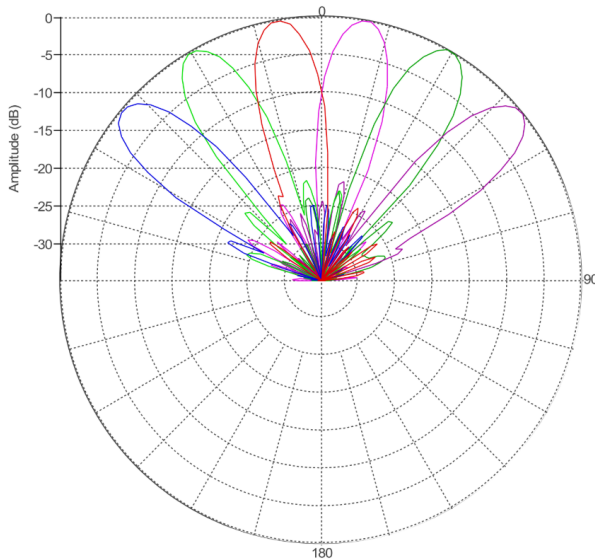

**Vertical Pattern at 2° and 10° (3.7GHz)**

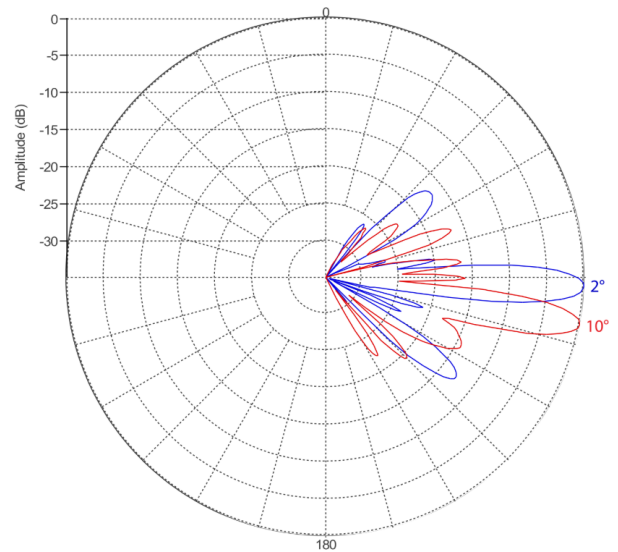

### TECHNICAL SPECIFICATIONS

Frequency	3300 – 4200 MHz
Gain	24.1dBi
VSWR	<1.5:1
Polarization	Dual Slant ±45°
Horizontal Coverage	120°
Horizontal Beamwidth (3dB level)	12°
Vertical Beamwidth (3dB level)	6.5°
Beam Cross-over	8dB typical
Total Number of Beams	6
Number of Ports per Beam	4
Number of Ports Total	24
RET (AISG & SBT)	2°-10°
1st Upper Side Lobe Suppression	15dB
Azimuth Sidelobe Level	-18dB
Front to Back Ratio @ 180°	28dB
Isolation Port to Port - Polarization	28dB
Isolation Port to Port - Beam	28dB
Power Rating	150W per port
Intermodulation	<-153dBc
Impedance	50 ohm
Connector Quantity and Type	24 x 4.3-10 female

### MECHANICAL DATA

Dimensions (H x W x D)	148 x 56.1 x 54.6 cm 58.3 x 22.1 x 21.5 inch
Antenna Weight	45.9 Kg 101.2 lbs
Radom	Fibreglass
Mounting	Standard pipe mount Compatible pipe diameter: 6.1 – 11.4 cm 2.4 – 4.5 inch

### ENVIRONMENTAL RATINGS

Humidity	95% RH @ +30°C
Temperature	-40°C to +70°C
Wind Load @ 150 km/hr	N/lbf Frontal: 536/120.5 Lateral: 731/164.3 Rear: 619/139.2

### CONNECTOR LAYOUT:

