

## MS-MBA-8

Lens Technology Enabled™ Multi-Beam Base-Station Antenna perfect for 3 to 9 sector LTE cell site deployments for best CINR results. Utilizes a patented spherical lens design with 3 isolated high-frequency (1710-2690MHz) cross-polarized beams. Each beam is made of four independent antennas and has 8 ports. There are four independent tilt settings per beam (0-30° tilt for each pair of cross-polarized elements).



Select antenna profile type from the drop-down list:

MBA-8

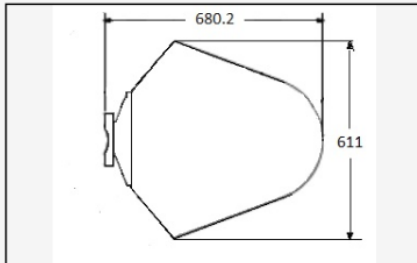

Note: Dimensions on the drawing shown in mm

### Antenna Model Number (optional)

MS MBA-8

### Velocity

Select Measurement Unit

km/h

Velocity

150

### Dimensions

Select Measurement Unit

mm

Length

1636

Length of antenna including end caps.

Do not include connectors, mounting brackets,

RET actuators/shrouds, lightning spikes

and other attached features.

Calculate

### Results

	Frontal	Lateral	Rear
Profile Drag Coefficient	1.1	1.42	1.29
Antenna Correction Coefficient	0.6	0.6	0.6
Antenna Drag Coefficient	0.66	0.85	0.77
Wind Load (N/lbf)	701 / 157.6	1007 / 226.4	822 / 184.8
Effective Drag Area(m <sup>2</sup> /ft <sup>2</sup> )	0.66 / 7.1	0.95 / 10.2	0.77 / 8.33

Print